

# Lead Screw

Linear actuation for positioning tasks  
PRECiStep® Technology

For combination with  
Stepper Motors: AM0820, AM1020, ADM1220S,  
AM1524

## Series M2,5 x 0,25 x L1

Nominal diameter	2,5	mm
Pitch	0,25	mm
Material	Stainless steel	

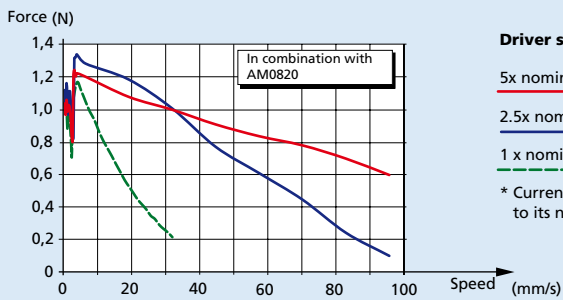

**Driver settings**  
5x nominal voltage \*  
2.5x nominal voltage \*  
1 x nominal voltage  
\* Current limited to its nominal value

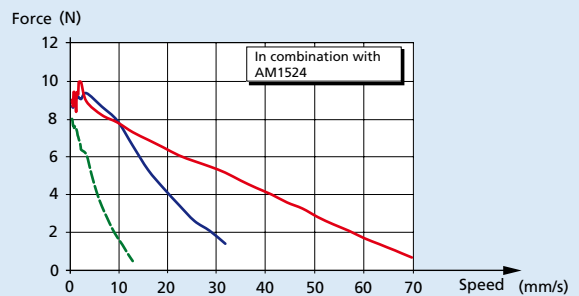
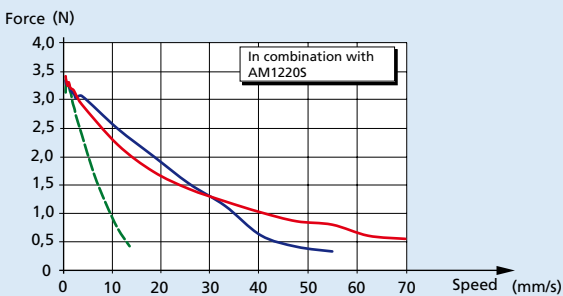
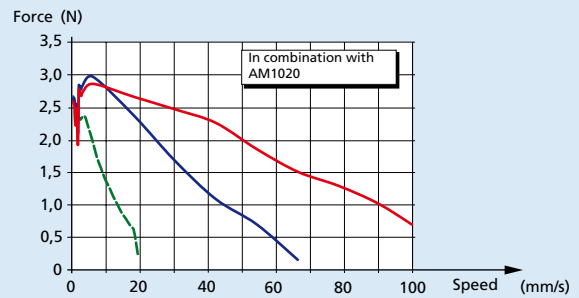

**Important notes:** The thrust curves include already a safety factor for the use of the stepper motor.  
Please read the "Technical information" for a better understanding of the curves.

Ordering information	L1 (mm) =	15	25	Custom
Order code (no bearing tip)		M2,5x0,25x15	M2,5x0,25x25	M2,5x0,25xL1*
Order code (with bearing tip)		M2,5x0,25x15T	M2,5x0,25x25T	M2,5x0,25xL1*T

\* For custom length, please inquire with your point of sales

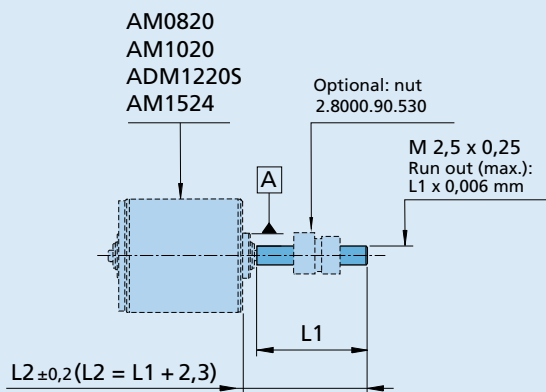

**M2,5 x 0,25 x L1**

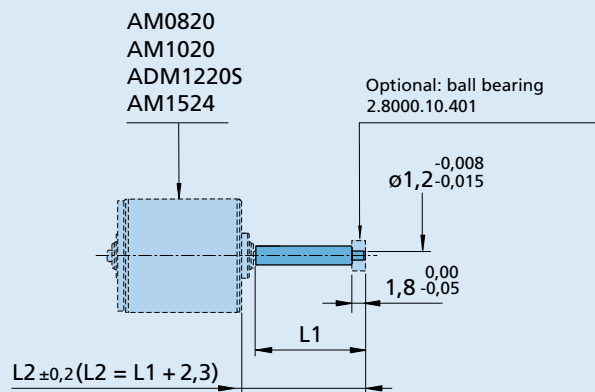

Version with bearing tip  
**M2,5 x 0,25 x L1 T**

# Lead Screw

Optional nuts and bearings  
PRECIstep® Technology

## Options

For M1,2 x 0,25 Lead screws

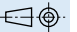
Scale 2:1 

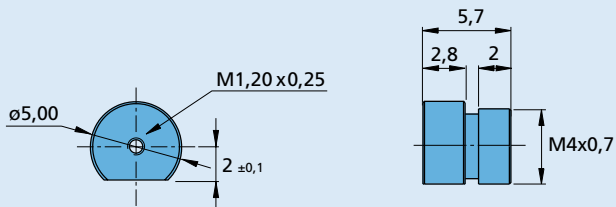

Nut Part No. 2.8000.90.526, Self-lubricating synthetics material

For M1,6 x 0,35 Lead screws

Scale 2:1 

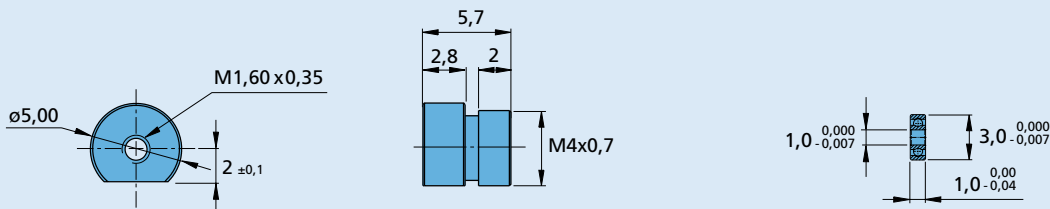

Nut Part No. 2.8000.90.527, Self-lubricating synthetics material

Bearing for leadscrew tip Part No. 2.8000.08.401

For M2,0 x 0,2 Lead screws

Scale 2:1 

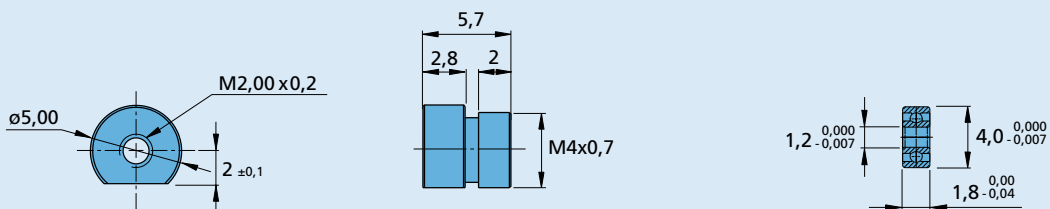

Nut Part No. 2.8000.90.528, Self-lubricating synthetics material

Bearing for leadscrew tip Part No. 2.8000.10.401

For M2,5 x 0,25 Lead screws

Scale 2:1 

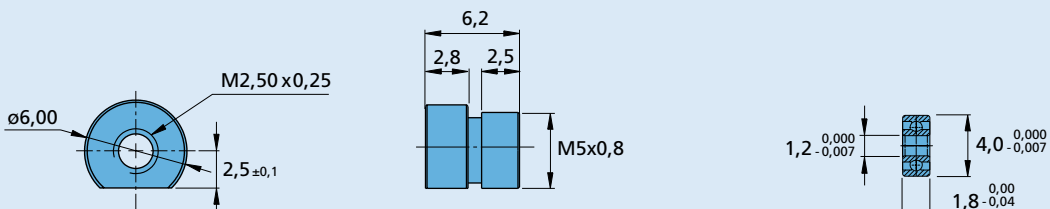

Nut Part No. 2.8000.90.530, Self-lubricating synthetics material

Bearing for leadscrew tip Part No. 2.8000.10.401

For M3,0 x 0,5 Lead screws

Scale 2:1 

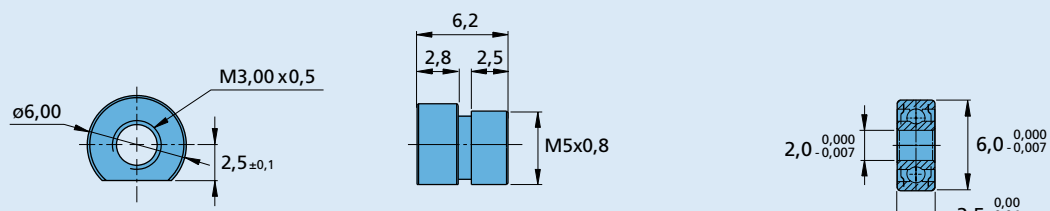

Nut Part No. 2.8000.90.531, Self-lubricating synthetics material

Bearing for leadscrew tip Part No. 2.8000.22.450