

Lead Screw

Linear actuation for positioning tasks
PRECiStep® Technology

For combination with
Stepper Motors: AM0820, AM1020, ADM1220S,
AM1524

Series M2 x 0,2 x L1

Nominal diameter	2,0	mm
Pitch	0,2	mm
Material	Stainless steel	

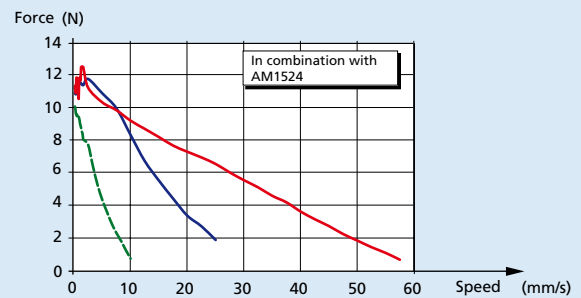
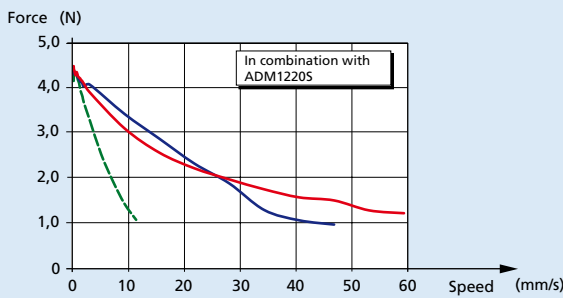
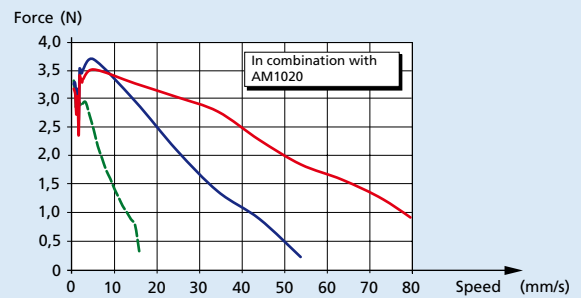
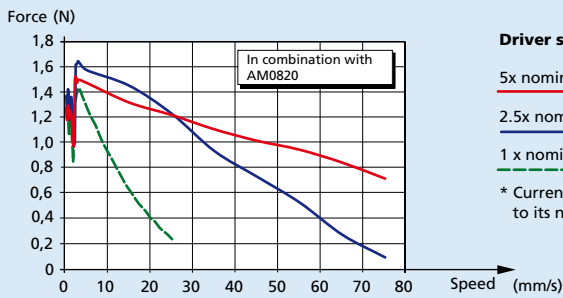

Important notes: The thrust curves include already a safety factor for the use of the stepper motor.
Please read the "Technical information" for a better understanding of the curves.

Ordering information	L1 (mm) =	15	25	28/30	Custom
Order code (no bearing tip)		M2x0,2x15	M2x0,2x25	M2x0,2x30	M2x0,2xL1*
Order code (with bearing tip)		M2x0,2x15T	M2x0,2x25T	M2x0,2x28T	M2x0,2xL1*T

* For custom length, please inquire with your point of sales

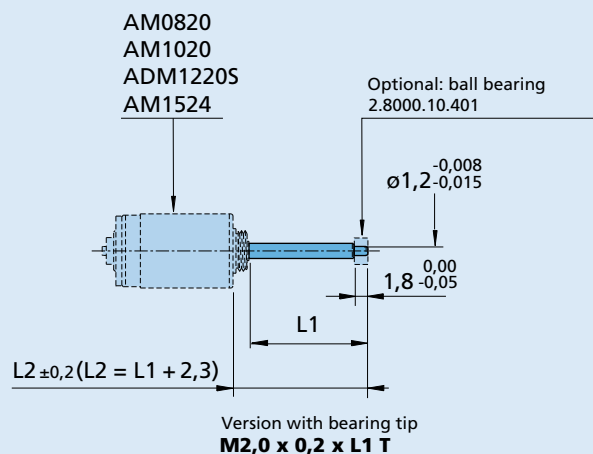
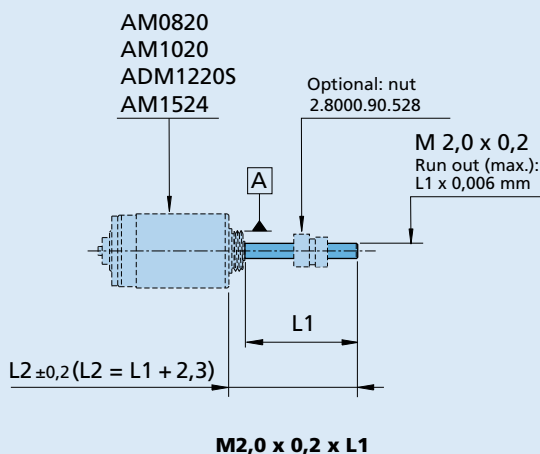

Lead Screw

Optional nuts and bearings
PRECIstep® Technology

Options

For M1,2 x 0,25 Lead screws

Scale 2:1 

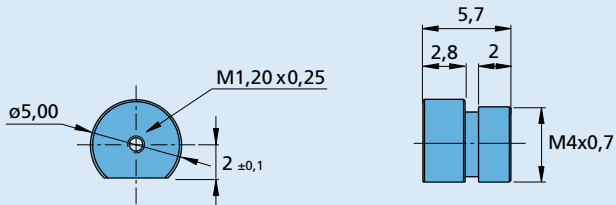

Nut Part No. 2.8000.90.526, Self-lubricating synthetics material

For M1,6 x 0,35 Lead screws

Scale 2:1 

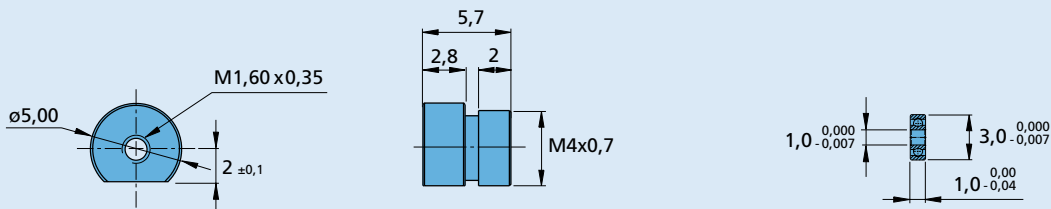

Nut Part No. 2.8000.90.527, Self-lubricating synthetics material

Bearing for leadscrew tip Part No. 2.8000.08.401

For M2,0 x 0,2 Lead screws

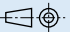
Scale 2:1 

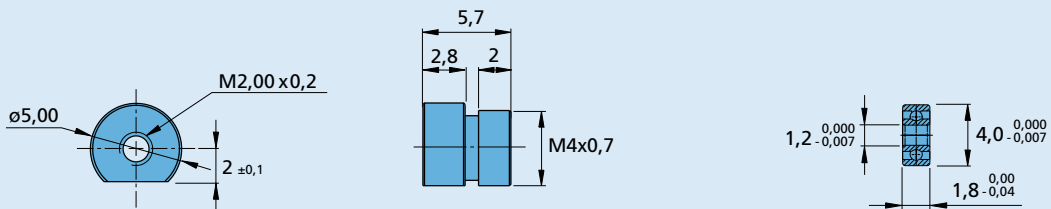

Nut Part No. 2.8000.90.528, Self-lubricating synthetics material

Bearing for leadscrew tip Part No. 2.8000.10.401

For M3,0 x 0,5 Lead screws

Scale 2:1 

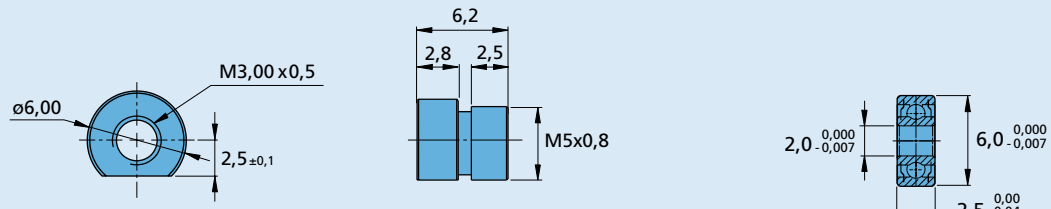

Nut Part No. 2.8000.90.531, Self-lubricating synthetics material

Bearing for leadscrew tip Part No. 2.8000.22.450